



Virtus Installation Guide

Virtus

62, 62.2, 63, 63.2

Components

MW6, MW6.2, MT120N,
VWB25.4, MXR200.4,
MXR300.4V

Dear Customer,

Thank you for choosing Morel for your car audio speaker solution.

Morel prides itself on engineering and producing the best high-fidelity speaker systems.

We hope you enjoy your Virtus speakers for years to come.

If you have any questions, please contact your Morel dealer or Morel support at

www.morelhifi.com

Virtus Components

6.5" Woofer



X2

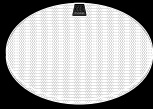

X2



X8



X8

MT120N Tweeter



X2



X2



X2



X4



X2



X2



X2
SURFACE
OPTIONS

VWB25.4 Midrange

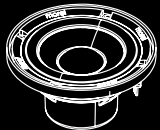

X2



X2



X8



X8

MXR200.4/MXR300.4V Crossover

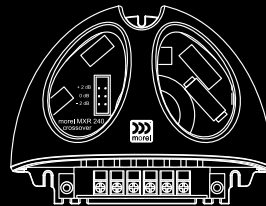

X2



X6



X6

Virtus Woofer, Tweeter, Crossover mounting

Unit 6.5"

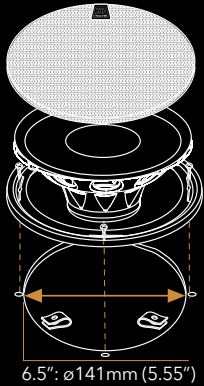

VWB25.4 Midrange

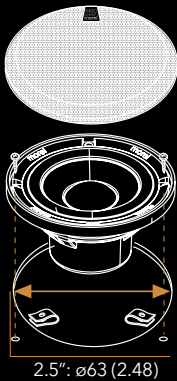

MT120N Tweeter

Flush Mount

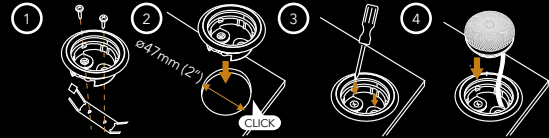

Surface Mount

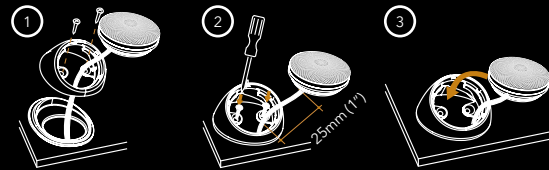

Crossover

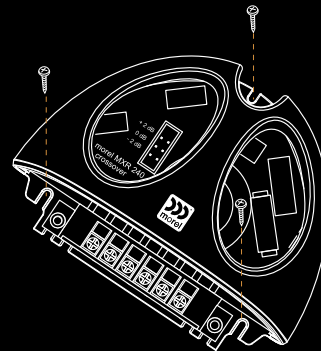

2-WAY System

2-WAY System Wiring

ACTIVE SET UP

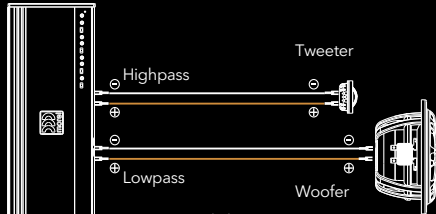

Recommended Active Crossovers
2-Way Component Systems
Tweeter HP: 2,800Hz @ 12dB or 24dB slope
Woofer LP: 2,800Hz @ 12dB or 24dB slope

PASSIVE SET UP

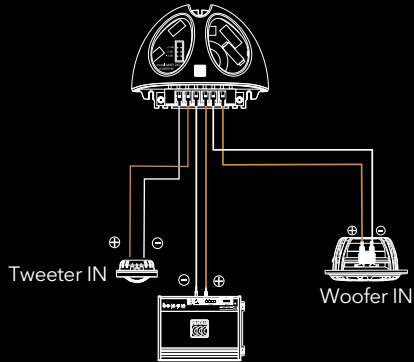

2-WAY System Alignment

Use the red jumper to determinate the tweeter +/- dB level

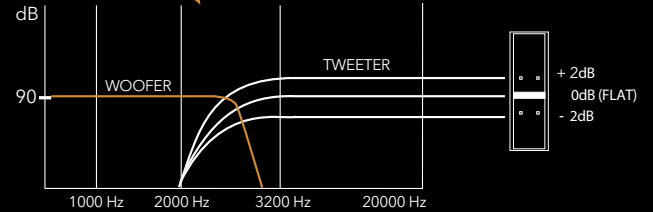
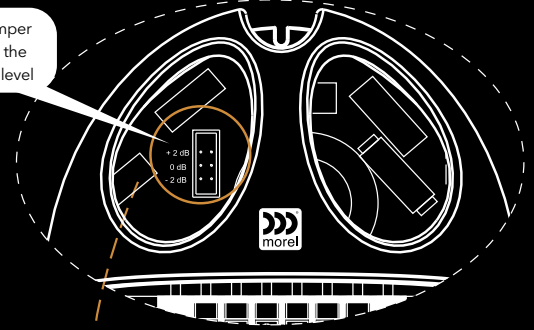

3-WAY System

3-WAY System Wiring

ACTIVE SET UP (Outputs must be filtered)

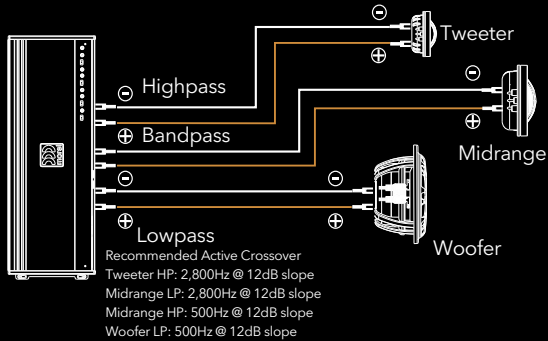

PASSIVE SET UP

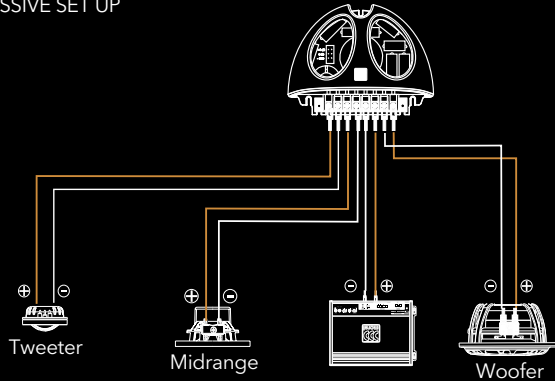

3-WAY System Alignment

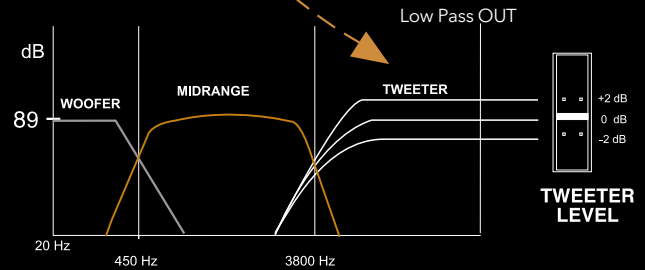
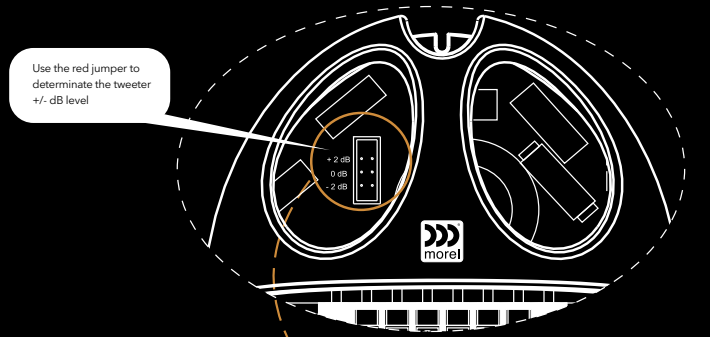

Specifications

DRIVER UNIT	VIRTUS MW6	VIRTUS MW6.2
Nominal Impedance (Ohms)	4	2
Power Handling Wrms	140	120
Max. Trans.Pwr Handling Wrms	300	260
Sensitivity (2.83V/1M)	88 dB	90 dB
Frequency Response Hz	55-4000	55-4000
Resonant Freq. Fs Hz	65	65.7
Voice Coil Diameter mm (inch)	54 (2.1)	54 (2.1)
Voice Coil Height mm (inch)	10 (0.4)	10 (0.4)
Voice Coil Type/ Former	Aluminum	Aluminum
Voice Coil Wire	Hexatech™ aluminum	Hexatech™ aluminum
DC Resistance (Ohms)	3.5	1.9
Voice Coil Induct. @1 kHz (mH)	0.33	0.10
Magnet System	Double ferrite rear vented	Double ferrite rear vented
HE-Magnetic Gap Height mm (inch)	4 (0.16)	4 (0.16)
B-Flux Density (T,M)	0.65	0.68
BL Product/BXL	3.41	2.95
Max. Linear Ex./Xmax mm (inch)	6±3 (0.23±0.118)	6±3 (0.23±0.118)
Suspension Compliance CMS - mm/N	0.57	0.42
Electrical Q Factor QES	1.3	1.27
QTS	0.9	0.9
QMS	2.88	3.09
Mech.Resistance RMS - Ohm/meter	1.49	1.84
Moving Mass MMS - gr/ ounce	10.67 (0.38)	13.82 (0.48)
Equiv. Can Air Load VAS - L (cu.ft)	11.38 (0.45)	8.76 (0.30)
Effective Piston Area SD sq.cm (sq. inch)	119 (18.45)	119 (18.45)
Cone Type	Formed Paper	Formed Paper
Cone Material	Composite cellular fiber	Composite cellular fiber
Unit Diameter mm (inch)	165 (6.50)	165 (6.50)
Mounting Depth mm (inch)	61 (2.36)	61 (2.36)
Mounting Cutout mm (inch)	141 (5.55)	141 (5.55)
Net Weight Kg (lb)	0.739 (1.61)	0.734 (1.62)

TWEETER / MIDRANGE	VWB25.4	MT120N (62.2)	MT120N (62)
Nominal Impedance (Ohm)	4	4	8
Power Handling (WRms)	40	80	80
Max Transient Power Handling W (10ms)	80	250	250
Sensitivity (2.83V/1M) dB	86	91	90
Frequency Response Hz	90-20000	1800-22000	1800-22000
FS Hz	110	1200	1200
Voice Coil Diameter mm (inch)	20 (0.78)	28 (1.125)	28 (1.125)
Voice Coil Former	Fiberglass	Aluminium	Aluminium
Voice Coil Wire	Copper	Copper	Copper
DC Resistance Ohm	5.2	4	5.2
Magnet System	Double Neodymium	Neodymium	Neodymium
Cone / Dome Type	Formed Aluminum	Acuflex™ hand coated soft dome	Acuflex™ hand coated soft dome
Cone / Dome Material	Aluminum	Silk	Silk
Unit Diameter mm (inch)	77 (3)	43.00 (1.69)	43.00 (1.69)
Mounting Depth mm (inch)	34.2 (1.34)	13.2 (0.52)	13.2 (0.52)
Mounting Cutout mm (inch)	63 (2.48)	47.00 (2)	47.00 (2)
Net Weight Kg(lb)	0.15 (0.33)	0.07 (0.15)	0.07 (0.15)

CROSSOVER	MXR200.4	MXR300.4V
Crossover Point	W: 2200Hz / 18dB T: 2200Hz / 12dB	W: 500Hz / 12dB M: 18dB/ 2800Hz/ 12dB T: 2800Hz / 12dB
Crossover Controls	Tweeter+/- 3dB	Tweeter+/- 2dB
Wiring Options	N/A	N/A

* Moral operates a policy of continuous product design improvement, consequently specifications are subject to alteration without prior notice.

Wishing you many years of sound enjoyment!



Morel, Ness Ziona, 70400 Israel.
Tel: +972-8-9301161
Fax: +972-8-9301312
E-mail: info@morelhifi.com

Morel America, Chandler, AZ, USA
Toll free number: 1-877-667-3511
Fax: 1-718-721-1560
E-mail: info@morelamerica.com

www.morelhifi.com